

Set Up Your iPad

Step 1: Open the Settings app

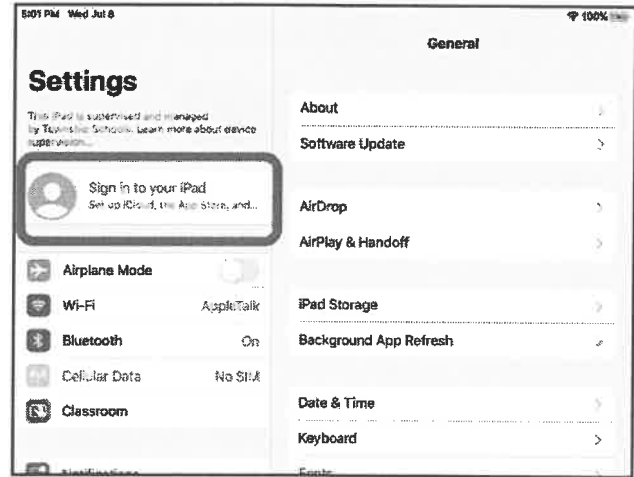

Step 2: Tap "Sign into your iPad"



Step 3: Enter your IPS email address and click "Next"

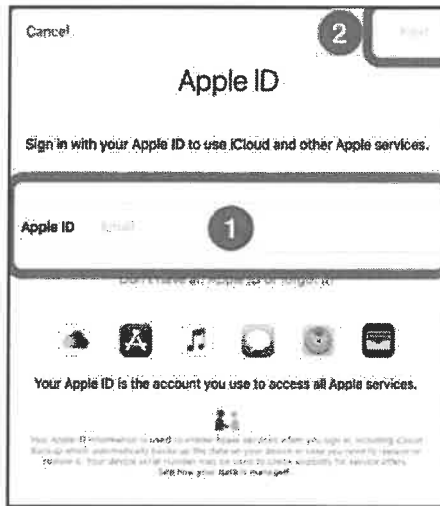

Step 4: Click "Continue"

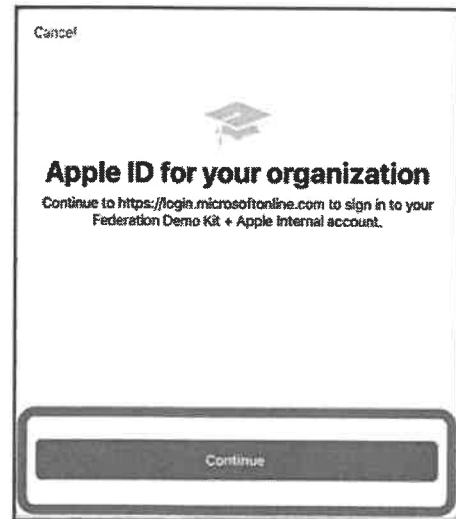

Students:

username = `studentid@students.myips.org`
 password = birthdate with slashes, no leading zeros

Staff:

username = IPS email address
 password = IPS password

Step 5: Enter your password and tap “Sign In”



Step 6: Tap “Yes” to stay signed in.
You are now signed into iCloud.

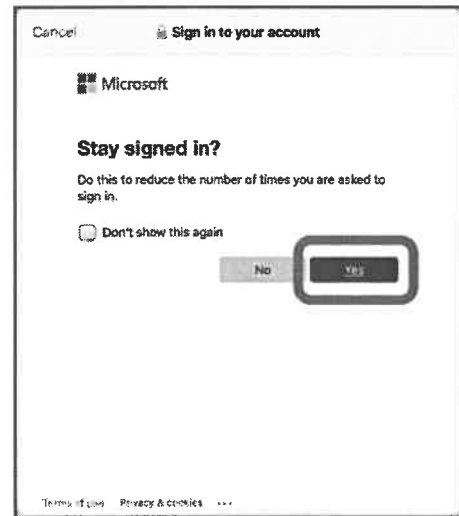

Step 7: If prompted for Proxy Authentication, click Settings.



Your iPad is now ready to use.
Press the Home button on your iPad to return to the Home Screen.

And then enter the user's email and password.



Students:

username = studentid@myips.org
password = birthdate with slashes, no leading zeros

Staff:

username = IPS email address
password = IPS password



Home Button